

*Villas*  
DE ALLENDE

Sharyland/McAllen's premiere  
spanish-colonial community



AN INCREDIBLE PLACE TO CALL HOME  
LOCATED ON THE CORNER OF 495 & TAYLOR RD

**VILLAS DE ALLENDE** is a private & architecturally controlled subdivision for a timeless and aesthetically pleasing environment for homeowners. This Hand-Selected location is surrounded by award winning schools, entertainment and minutes away from prime shopping locations across Sharyland & McAllen.

The PERFECT  
LOCATION to Build  
Your FOREVER  
HOME

Call Now to Reserve

956.867.8363 | 956.239.0487





Taylor Rd.

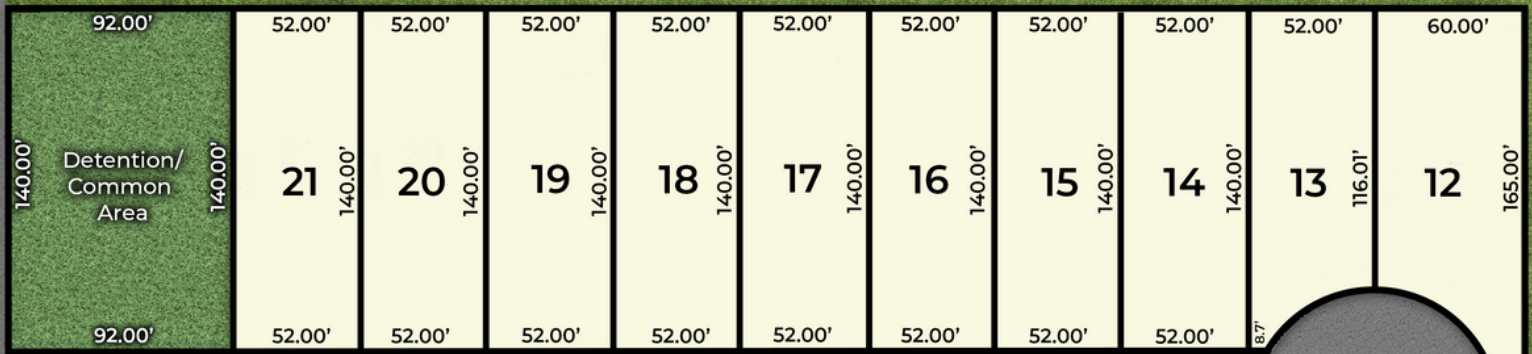

Pecan Ave.

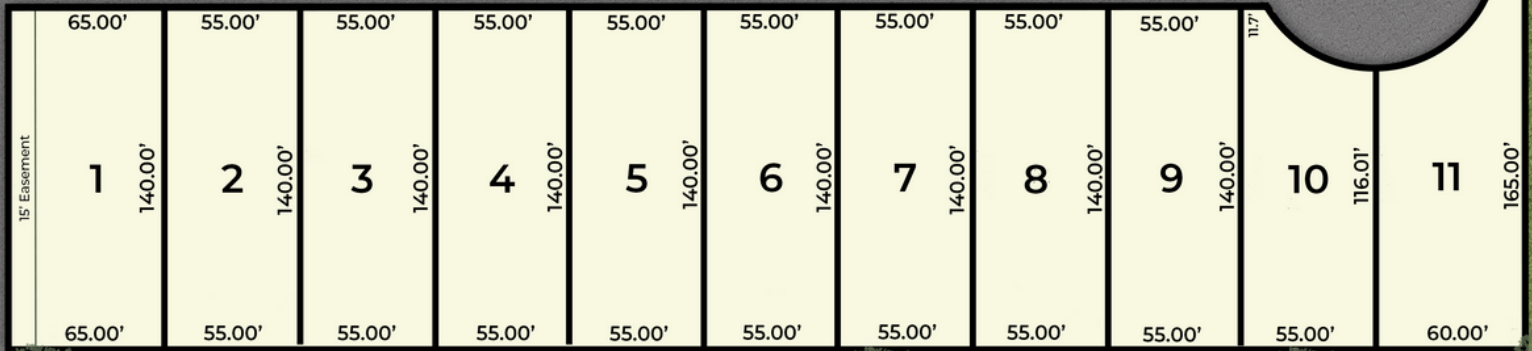

Home Elevations

\*Please inquire about prices by calling our office line below.

Lot	Size	Price
1	9,100	Call
2	7,700	Call
3	7,700	Call
4	7,700	Call
5	7,700	Call
6	7,700	Call
7	7,700	Call
8	7,700	Call
9	7,700	Call
10	6,932	Call
11	7,936	Call
12	7,936	Call

Lot	Size	Price
13	6,512	Call
14	7,280	Call
11	7,936	Call
12	7,936	Call
13	6,512	Call
14	7,280	Call
15	7,280	Call
16	7,280	Call
17	7,280	Call
18	7,280	Call
19	7,280	Call
20	7,280	Call
21	7,280	Call

## Subdivision Specifics & Restrictions

- Clay Tile Roof
- Stucco, Stone & Cantera Finishes
- Minimum SqFt: (1-Story) 1,850  
(2-Story) 2,000
- Electricity Provided by AEP
- HOA Fees: \$750/Year
- Fiber Optic Provided by AT&T

Sharyland

Water Supply Corporation



AT&T Fiber

Call Now to Reserve

956.867.8363 | 956.239.0487





Conveniently located at the cusp of Sharyland & McAllen with easy access to amazing schools, national retailers, shopping and entertainment. Villas De Allende gives you the opportunity to live close to everything you need.

Call Now to Reserve

956.867.8363 | 956.239.0487

